

 NEVER COMPROMISE ON QUALITY AND SAFETY

CAR LIFT CATALOG

 **Schneider**TM
Lift & Escalator
— Since 1992 —
www.asia-schneider.com 02 948 1663



*Actual Product might differ from pictures.

STANDARD CABIN FOR CAR LIFT

CAR CEILING
ASC-A-02 Laminated Painted Steel
with LED downlight

CAR WALL
Painted Steel

CAR DOOR
Painted Steel

LANDING DOOR
Painted Steel

COP & HOP
304 Hairline Stainless Steel with Dot-Matrix LED Screen
and ASB-M-01 push button

CAR FLOOR
Checkered Plate

CAR CEILINGS



ASC-A-01



ASC-A-02

*Actual Product might differ from pictures.

ASC-A-01

Laminated Painted Steel
with LED Lighting and ventilation system

ASC-A-02

Integrated Painted Steel
with LED Down Lights and ventilation system

DISPLAY TYPES



DOT-MATRIX



BLUE-SEGMENT
LCD (OPTIONAL)

PUSH BUTTONS



ASB-M-01



ASB-M-02



ASB-M-03



ASB-M-04



ASB-M-05



STANDARD



OPTIONAL

*Actual Product might differ from pictures.

AS-A-HOP 01
Hairline Stainless Steel with
Dot-Matrix LCD Display

AS-A-HOP 02
Hairline Stainless Steel with
Blue-Segment LCD Display

ASB-M-01
Round Hairline Stainless Steel
with Braille button.

ASB-M-03
Round Hairline Stainless Steel
with Braille button.

AS-A-COP 01
Hairline Stainless Steel with
Dot-Matrix LCD Display

AS-A-COP 02
Hairline Stainless Steel with
Blue-Segment LCD Display

ASB-M-02
Round Hairline Stainless Steel
with Goldish background color

ASB-M-04
Square Hairline Stainless Steel.

ASB-M-05
Square Hairline Stainless Steel
with Braille button.

CAR FLOORS

ASF-A-01



ASF-A-02

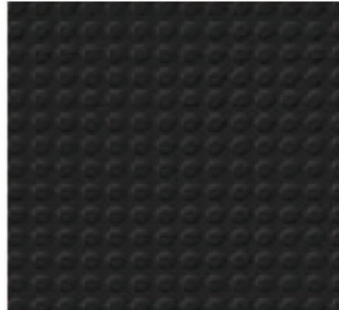

ASF-A-03



CAR WALL



PS01



PS02



PS03

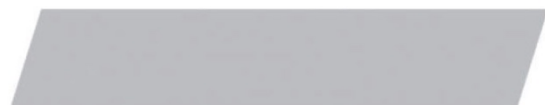

PS04

*Actual Product might differ from pictures.

PS01
Gray

PS03
Green

ASF-A-01
Painted Steel Checkered Plate

ASF-A-03
Stainless Steel Checkered Plate

PS02
Cream

PS04
Space Gray

ASF-A-02
Black Rubber Plate

Lift Shaft-SECTION VIEW

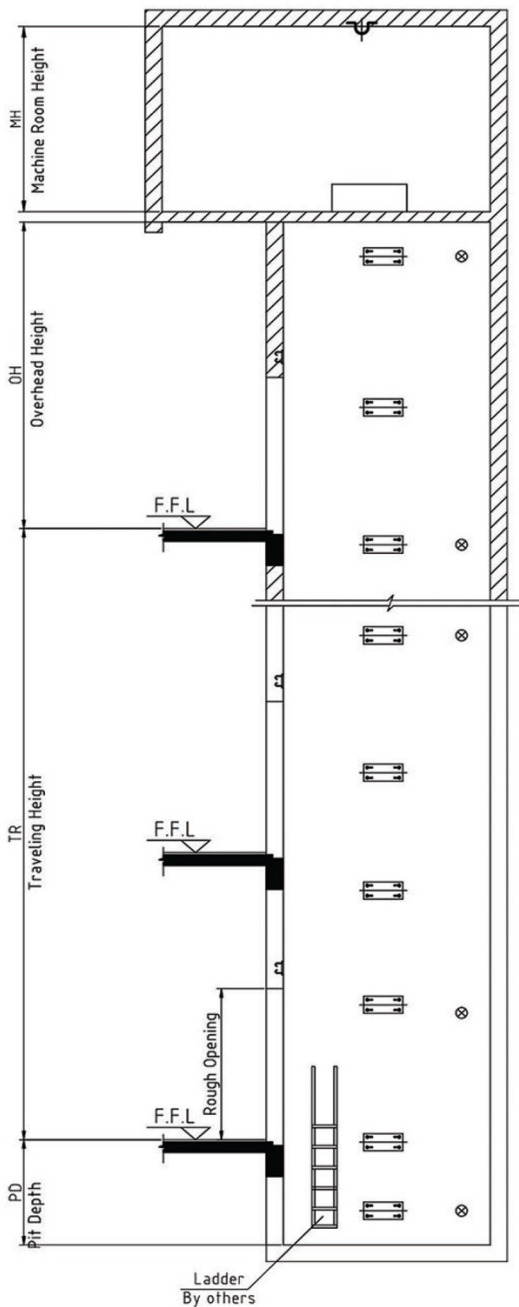

MACHINE ROOM PLAN

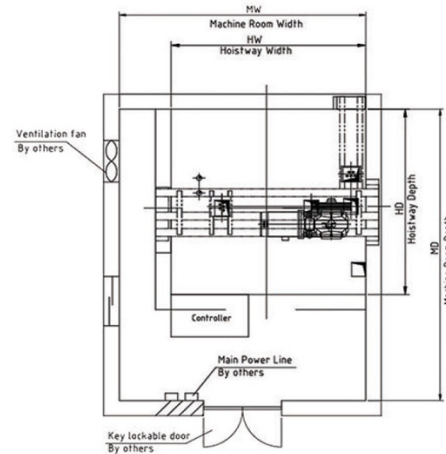

HOISTWAY PLAN

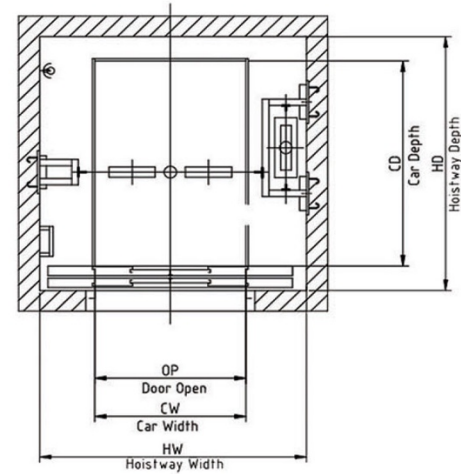

PLANNING GUIDE FOR DIMENSIONS (Overhead and Pit)

Capacity Load(kg)	OH (mm)	PIT (mm)	Car Clear Height (CIH) (mm)	Door Height (mm)
2000	4500(0.5m/s)	1400	2200 (without false ceiling)	2100
	4800(1.0m/s)			
3000/3500	4600	1600		
4000	4600	1600		
5000	5000	1600	2400 (without false ceiling)	2300

PLANNING GUIDE FOR DIMENSIONS (2000 - 4000kg)

Speed(m/s)	Max. Travel (m)	Capacity Load(kg)	Car Size	Door Opening(mm)	Std. Hoistway Size / HWxHD (mmxmm)	
			CWxCD(mmxmm)		Single Opening	Through Opening
0.5/1.0	40	2000	1700x2400	CO 1700, 4 pannels	3000x2950	3000x3000
0.5	40	3000	2000x2800	CO 2000, 4 pannels	3400x3350	3400x3400
		3500	2200x3000	CO 2200, 4 pannels	3800x3550	3800x3600
		4000	2000x3600	CO 2000, 4 pannels	3550x4150	3550x4200
		5000 *	2400x3600	CO 2400, 4 pannels	4050x4150	4050x4200

* 5000kg is with 6 car guide rails.

Hydro-Park AS2130



- 3000kg capacity makes it possible for all SUVs
- Commercial grade design
- 2150mm usable platform width makes it much easier for parking and retrieve
- Galvanized platform guarantees safety and long lifetime
- Anti-slip corrugated deck protects both vehicle and driver from possible slip and damage but still high-heel shoe friendly
- Hydraulic cylinder and chain drive system for smooth operation
- The pole with piston is chorming to anti-corrode to ensure its long using life

- Individual hydraulic power pack and control panel, both covered in the back of platform for security and rainproof
- Self-standing and self-support structure
- Electric key switch for security and safety
- A new "LOCK DOWN" button for platform sitting on locking tab to protect cylinder
- Automatic shut-off once operator releases the key switch
- Dynamic mechanical locks as "all the way" anti-falling device hold the platform in place
- Platform can be stopped at different heights to fit for various vehicles and ceiling heights
- Hydraulic overloading protection

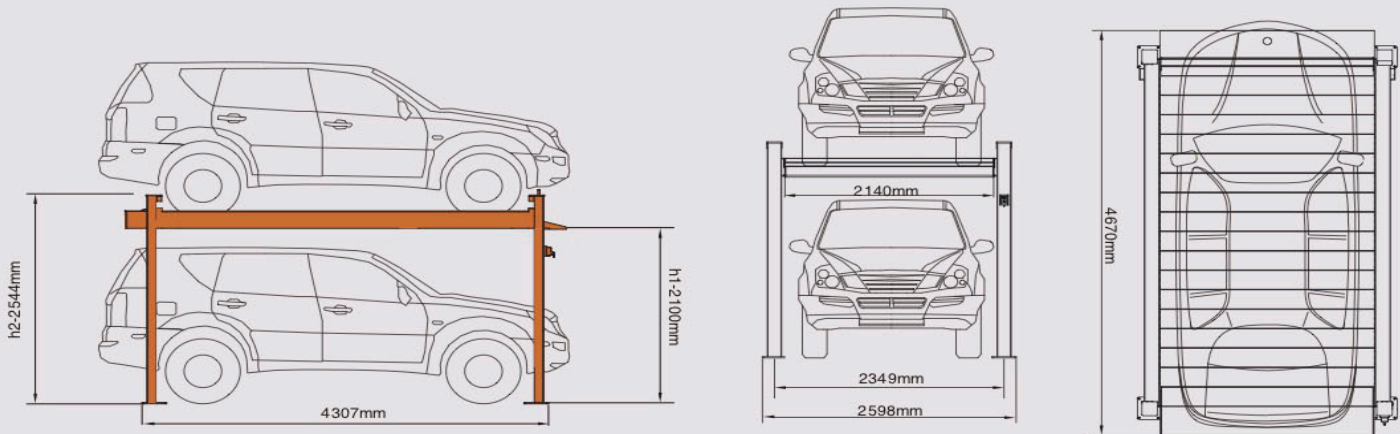

Lifting capacity	3000kg / 6600lbs
Lifting height	2100mm / 83 inches
Usable platform width	2140mm / 84 inches
Power Unit	2.2Kw hydraulic pump
Available voltage of power supply	100V-450V, 1 or 3 Phase, 50/60Hz
Operation mode	Key switch
Operation voltage	24V
Safety lock	Dynamic anti-falling lock
Lock release	Electric auto release
Rising/descending speed	< 40s
Finishing	Powder coating



Automatic shut-off key switch control with LOCK DOWN button



Hydraulic cylinder and chain drive system for smooth operation



Protective cover of power pack and control box for security and rain-proof



Mechanical anti-falling lock device to protect machine all the way

Hydro-Park AS2236



- 3600kg capacity makes it possible for heavy duty vehicles.
- 2100mm usable platform width makes it much easier for parking and retrieve.
- Unique mechanical detection will stop platform at once in case steel rope is loosen or cut off.
- Anti-slip diamond plates as drive way
- Lateral protection plates at two sides of platform will prevent vehicles going out.
- Electric key switch control for security and safety
- Automatic shut-off once operator releases the key switch
- LOCK DOWN button makes platform sit on

locking tabs to increase safety and rest the cylinder for longer lifetime.

- Hydraulic cylinder and steel rope drive system for smooth operation
- The pole with piston is chroming to anti-corrode to ensure its long using life
- Self-standing and self-support structure
- Dynamic mechanical locks as anti-falling device hold the platform in place
- Platform can be stopped at different heights to fit for various vehicles and ceiling heights
- Hydraulic overloading protection

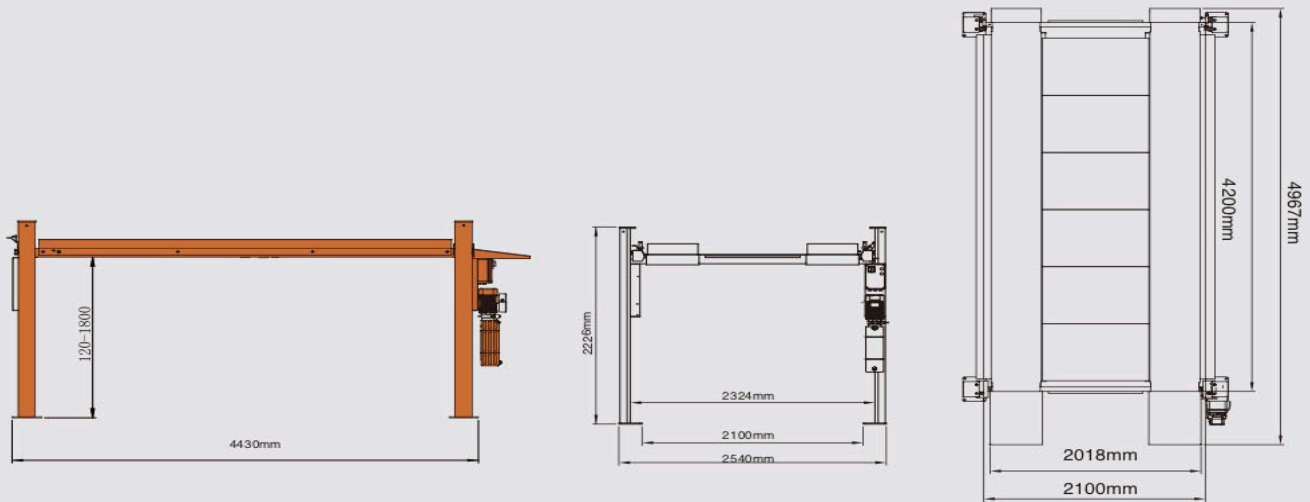

Lifting capacity	3600kg / 8000lbs
Lifting height	1800mm / 71 inches
Usable platform width	2100mm / 83 inches
Power Unit	2.2Kw hydraulic pump
Available voltage of power supply	100V-450V, 1 or 3 Phase, 50/60Hz
Operation mode	Key switch
Operation voltage	24V
Safety lock	Dynamic anti-falling lock
Lock release	Electric auto release
Rising/descending speed	< 40s
Finishing	Powder coating

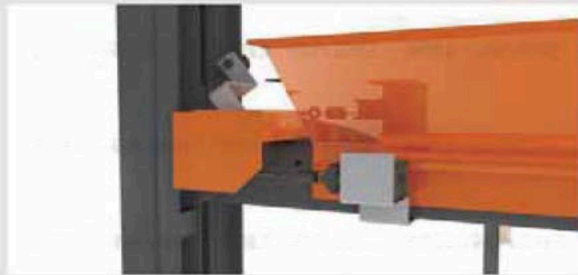

Electrical automatic locking system



Fashion car stopper



Unique mechanical steel rope detection mechanism



Wider platform space makes parking more convenient

Hydro-Park AS7125



- New commercial grade design released to the market
- Galvanized platform with wave plate for better parking
- Dual master & slave hydraulic lifting cylinders direct drive
- Individual hydraulic power pack and control panel
- Pit and back wall needed for structure supporting

- 2500kg capacity is available for both SUV and sedan
- Middle post sharing feature save cost and space
- Electric key switch for security and safety
- Automatic shut-off once operator releases the key switch
- Balance chain synchronization
- Single & double stacker for your choice
- Hydraulic overload protection

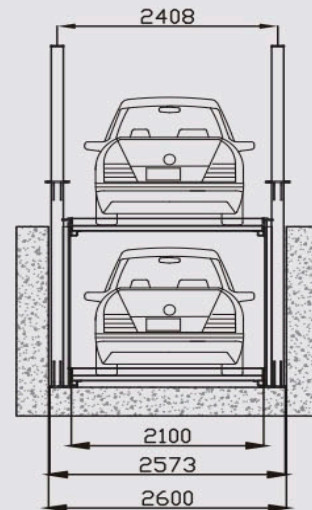
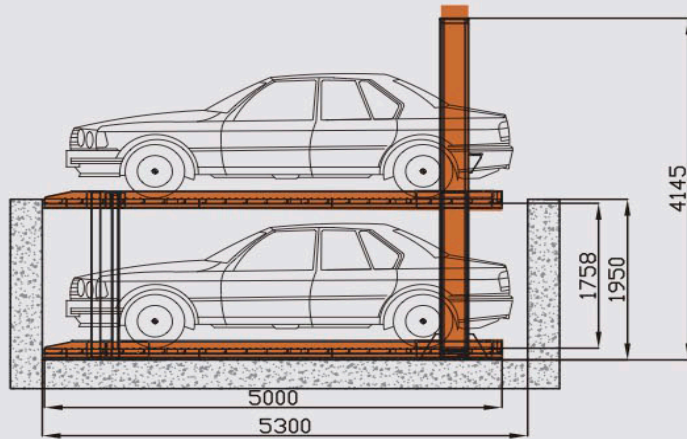

Lifting capacity	2500kg / 5500lbs
Lifting height	1820mm / 71.7 inches
Usable platform width	2100mm / 83 inches
Power Unit	4Kw hydraulic pump
Available voltage of power supply	100V-450V, 1 or 3 Phase, 50/60Hz
Operation mode	Key switch
Operation voltage	24V
Rising/descending speed	< 55s
Finishing	Powder coating



Middle post can be shared to save land space and cost



Convenient parking without moving the other car



VRC (Vertical Reciprocating Conveyor) is a transportation conveyor moving car from one floor to another, it is a highly customized product, which could be customized according to customer's different requirements from lifting height, lifting capacity to platform size!

FP-VRC is a kind of car or goods lift, and industry use vertical table lift

-Self-standing and self-support structure

- Hydraulic cylinder + steel chains drive system
- High precision and stable hydraulic drive system
- Automatic shut-off once operator releases the button switch
- Double chain design for higher safety
- High density chains with longer service life
- Remote control is optional
- Top quality diamond steel plate
- Hydraulic overloading protection available

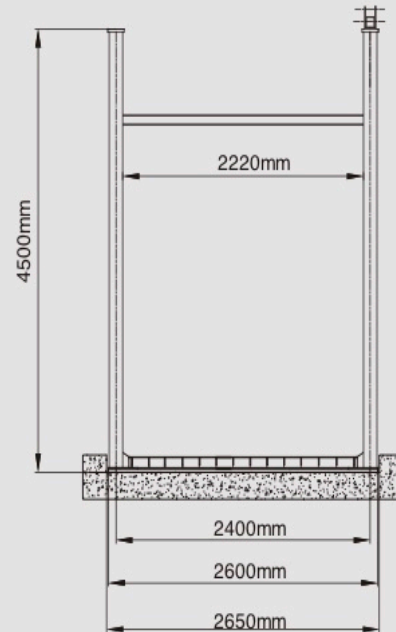
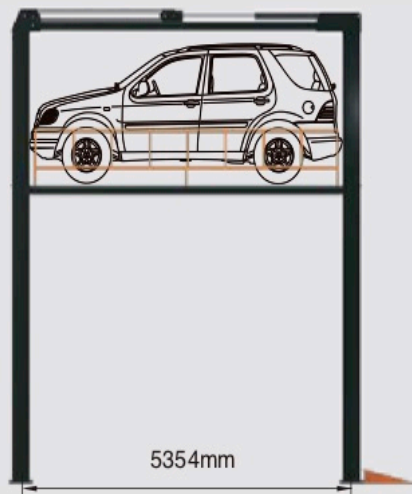

Lifting capacity	2,000-5,000 kg
Lifting height	2,000-12,000mm
Platform length	2000mm-6000mm
Platform width	2000mm-5000mm
Platform material	Diamond steel sheet (standard) / 4mm Aluminum steel sheet (optional)
No. of level	according to your requirement
Drive mode	Hydraulic(cylinder with double steel chains)
Operation	button switch (standard) / remote controller (optional)
Power pack	4 kw hydraulic power pump
Lifting speed	4m/min
Safety devices	Mechanical anti-falling lock
Finishing	Paint spray
Color	according to your requirement



VRC (Vertical Reciprocating Conveyor) is a transportation conveyor moving car from one floor to another, it is a highly customized product, which could be customized according to customer's different requirements from lifting height, lifting capacity to platform size.

S-VRC is a kind of car or goods lift, and industry use vertical table lift

- A foundation pit is needed for S-VRC
- The ground will be flat after S-VRC descend to bottom position
- Hydraulic cylinder direct drive system

- Double cylinder design
- High precision and stable hydraulic drive system
- Automatic shut-off once operator releases the button switch
- Small space occupation
- Pre-assembled structure makes easier installation
- Remote control is optional
- Double or triple levels of platforms are available to have more parking
- Top quality diamond steel plate
- Hydraulic overloading protection available

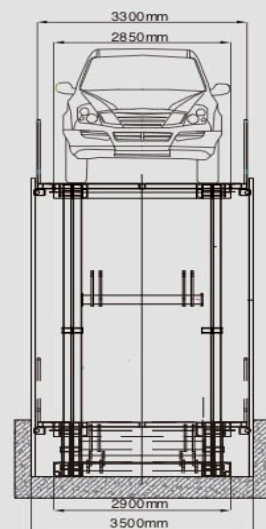
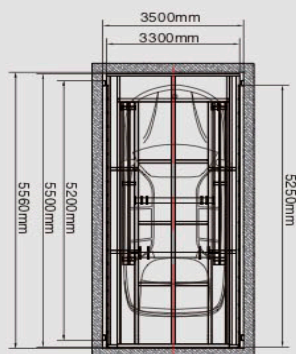
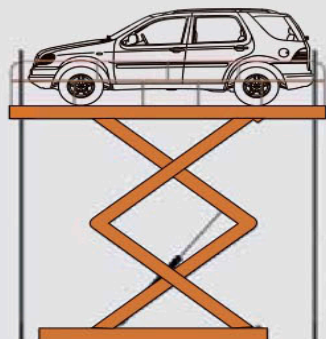

Lifting capacity	2,000-10,000 kg
Lifting height	2,000-10,000mm
Platform length	2000mm-6000mm
Platform width	2000mm-5000mm
Platform material	Diamond steel sheet (standard) / 4mm Aluminum steel sheet (optional)
Drive mode	Hydraulic(cylinder with double steel chains)
Operation	button switch (standard) / remote controller (optional)
Power pack	4 kw hydraulic power pump
Lifting speed	4m/ min
Safety devices	Mechanical anti-falling lock
Finishing	Paint spray

